



POWERED BY myQ®

2-BUTTON UNIVERSAL REMOTE CONTROL

MODEL: L992U

Product Manual



Overview

Your remote control is compatible with most major brands of garage door openers manufactured after 1993 that use photoelectric sensors located near the bottom of the garage door track. Your remote control can be programmed to operate up to two compatible garage door openers. Each button on the remote control works independently of the other and must be programmed separately. The images throughout this manual are for reference only and your product may look different.

⚠ WARNING

To prevent possible SERIOUS INJURY or DEATH from a moving gate or garage door:

- ALWAYS keep remote controls out of reach of children. NEVER permit children to operate, or play with the remote control transmitters.
- Activate gate or door ONLY when it can be seen clearly, is properly adjusted and there are no obstructions to door travel.
- ALWAYS keep gate or garage door in sight until completely closed. NEVER permit anyone to cross path of moving gate or door.



WARNING: This product can expose you to chemicals including lead, which are known to the State of California to cause cancer or birth defects or other reproductive harm. For more information go to www.P65Warnings.ca.gov.

The remote control is supplied with a visor clip.

The remote control has a keyring loop option. **Keyring is not included.** The recommended size of keyring to attach is 5/8".

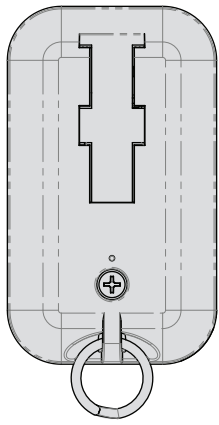
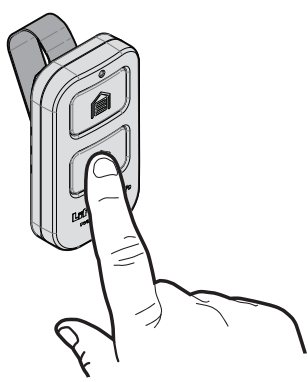

Tap the buttons below to navigate to a specific section of the manual.

Compatibility

Programming the Remote

Other important information:

Replacing the Battery

Replacement Parts

Additional Resources

Compatibility

If using the universal remote control with residential garage door openers, the remote control must be used with garage door openers manufactured after 1993 that utilize photoelectric sensors. The photoelectric sensors are always located on or near the bottom of the garage door track.

The universal remote control is compatible with the following brands that use a program button:

LiftMaster®	1993-Current
Chamberlain®	1993-Current
Craftsman®	1993-Current
Genie®	1995-Current
Overhead Door®	1995-Current
Linear®	1997-Current
Stanley®	1998
Wayne Dalton®	1999
Raynor®	1993-Current
Performax®	2016-Current
Xtreme Garage®	2016-Current
Sommer®	2013-Current
Ryobi®	2016-Current

Guardian®, Do-It®, Garage Master®, Master Mechanic®, Moore-O-Matic®, and True Value® are compatible with the universal remote control.

Programming the Remote

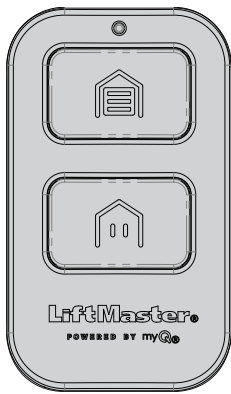

01 Prepare:

- **Read through the Instructions carefully.**
- Watch out for time sensitive instructions marked with an hourglass icon.
- Make sure the garage door is clear of ALL obstructions.
- Make sure the garage door opener has a working light. It will be needed for programming.



02 IMPORTANT: Your garage door opener has a button that is required to program your remote. Different brands and models vary in the location and description of that button. Consult your garage door opener product manual for the location of the button and steps required to place your garage door opener into programming mode. Next, locate and, if necessary, identify the color of your garage door opener's button required for programming (a ladder may be required and you may have to remove a light cover).

Examples:

LiftMaster / Chamberlain / Craftsman / Raynor

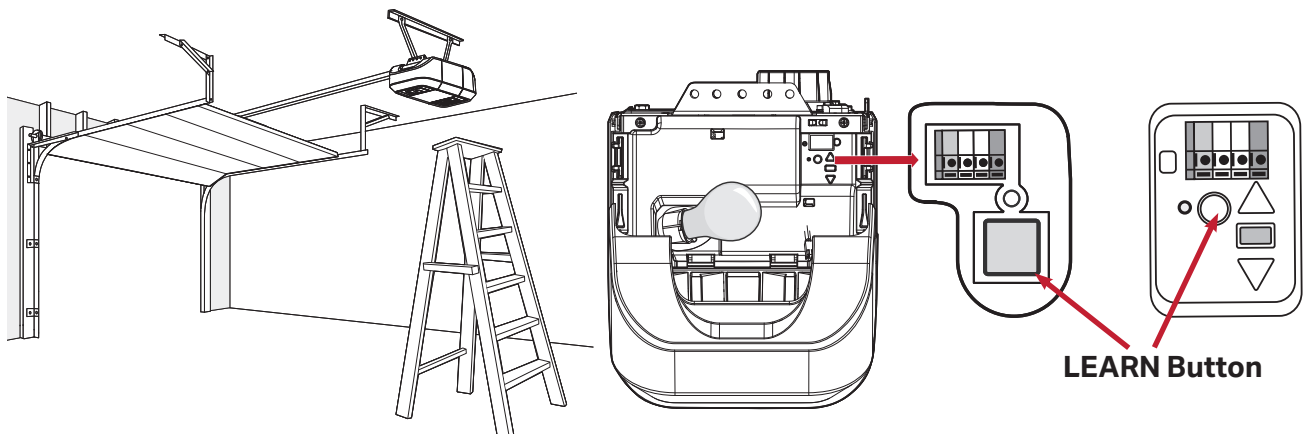

Genie

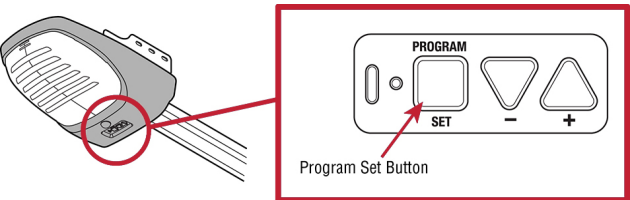

Wayne Dalton

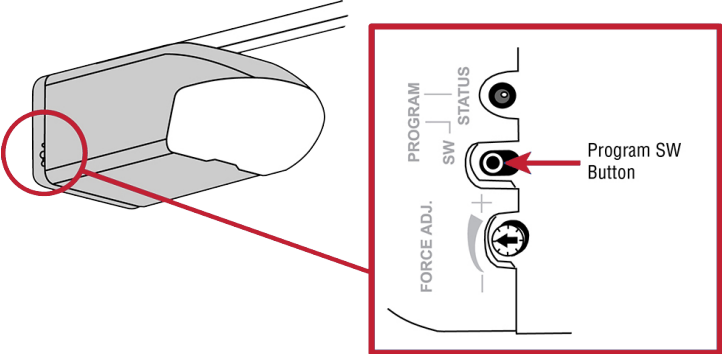

Programming the Remote (continued)

Examples (continued):

Linear

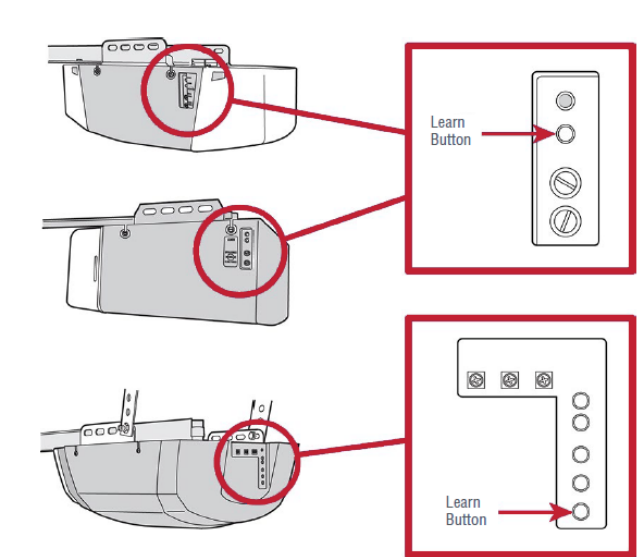

Guardian / Xtreme Garage / Performax

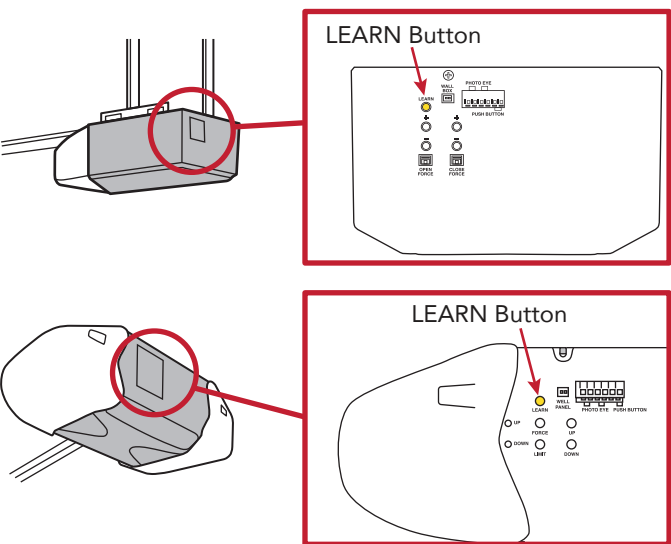

Sommer

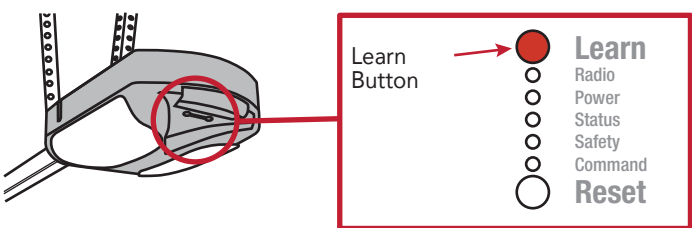

Stanley

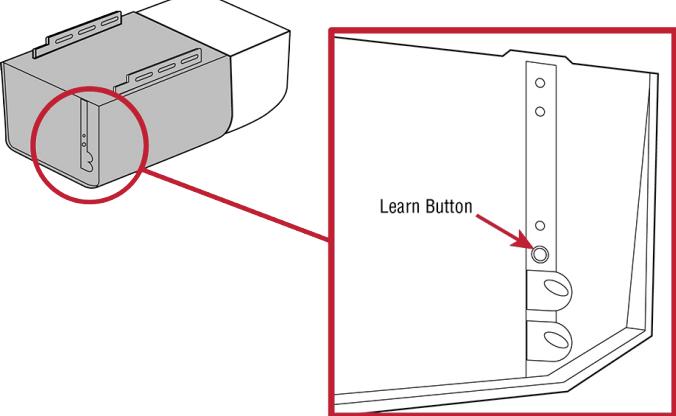

03 For remote programming instructions, follow the directions below:
For **LiftMaster, Chamberlain, Craftsman, or Raynor brand** garage door openers, **tap the LEARN button color icon** for your garage door opener below:

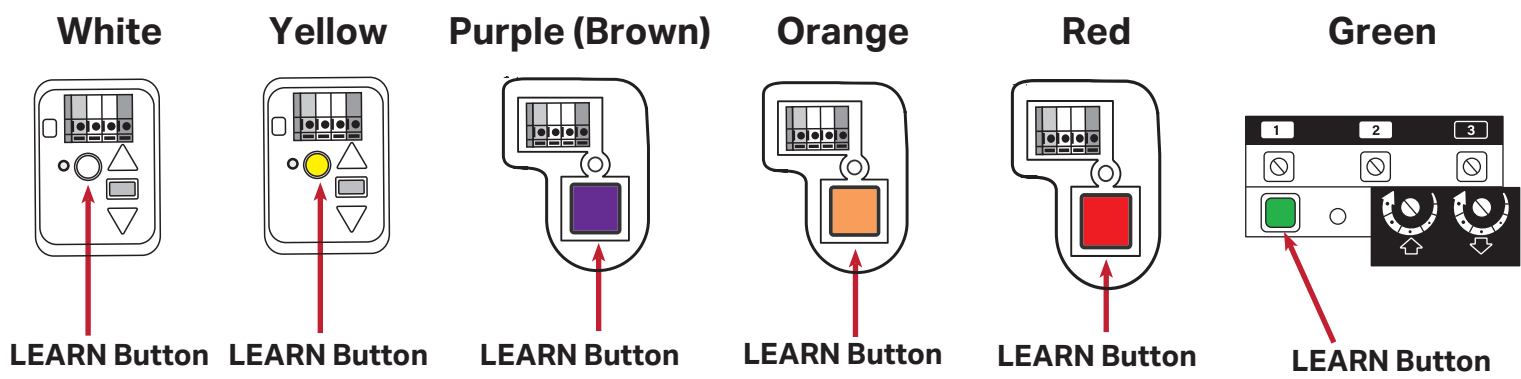

NOTE: The color of the purple LEARN button may fade with time and appear brown.

For **all other brands** of garage door openers, [tap here](#).

Options to Program Remote to a LiftMaster, Chamberlain, Craftsman, or Raynor Garage Door Opener with a Yellow LEARN Button



There are three ways to program your remote to a garage door opener with a yellow LEARN button. Tap your preferred method below.

Option 1: To program your remote using the myQ app, **tap the myQ app icon.**



Option 2: To program your remote using garage door opener’s LEARN button, **tap the LEARN button icon.**

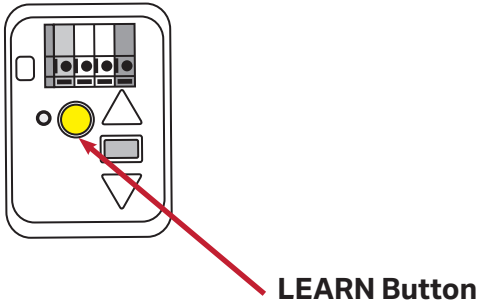

Option 3: To program your remote using garage door opener’s control panel, **tap the control panel icon.**

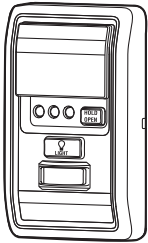

Program Remote to a LiftMaster, Chamberlain, Craftsman, or Raynor Garage Door Opener Using a Yellow, Purple, Orange, Red, or Green LEARN Button

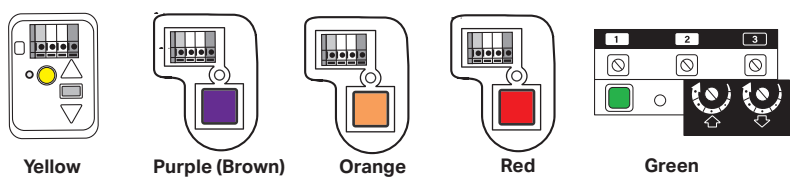

IMPORTANT: Read through all programming steps before you start.

01 Press and hold the two buttons on the remote simultaneously until the blue LED stays on (typically within 6 seconds).

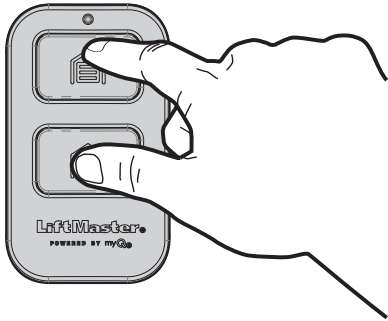

02 Press and **immediately** release the LEARN button.

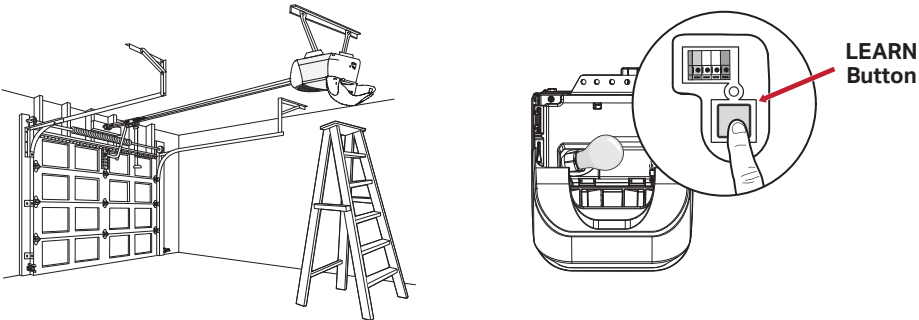

15 Seconds

03 **Within 15 seconds** of pressing the LEARN button, press and release the remote button you would like to program **three times**. The blue LED will flash intermittently.

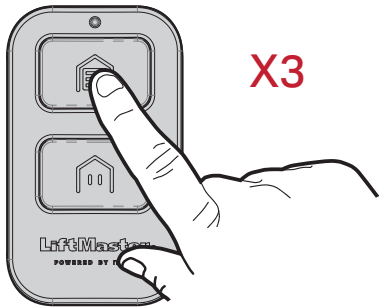

WARNING: Your garage door opener light will flash and your garage door will move.



3 Seconds

04 When your garage door moves, **within 3 seconds**, press and release any remote button.

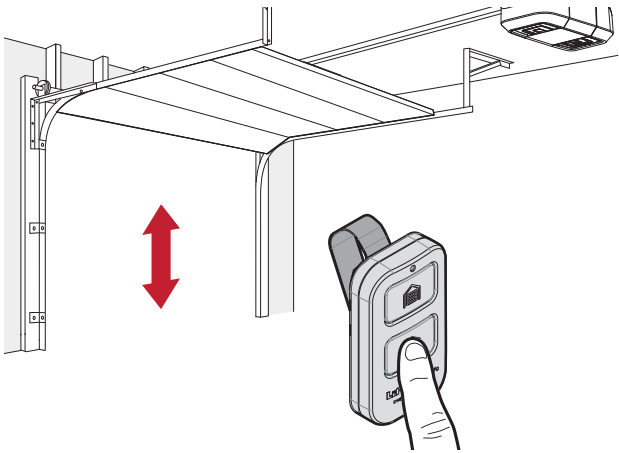

To test your remote has programmed successfully **tap here**.

Program Remote to a LiftMaster, Chamberlain, Craftsman, or Raynor Garage Door Opener with a Yellow LEARN Button Using the Control Panel



IMPORTANT: Read through all programming steps before you start.

01

Press and hold the two buttons on the remote simultaneously until the blue LED stays on (typically within 6 seconds).

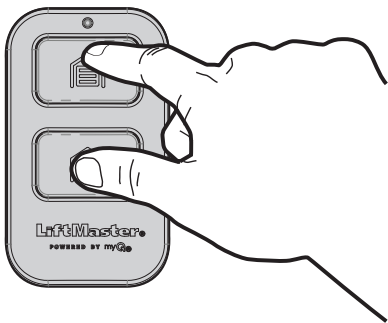

02

Follow the instructions below for your control panel model to set your garage door opener into programming mode.

Control Panel

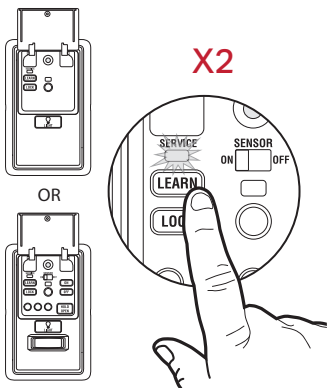

Lift the push bar. Press the LEARN button **twice**. The LED on the door control panel will pulse repeatedly.

Push Button Door Control

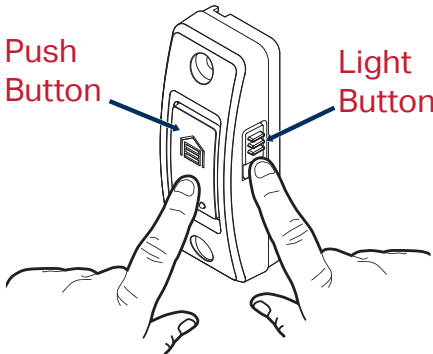

Press and hold the light button, then press and release the push button. The button LED will begin to flash.

Smart Control Panel

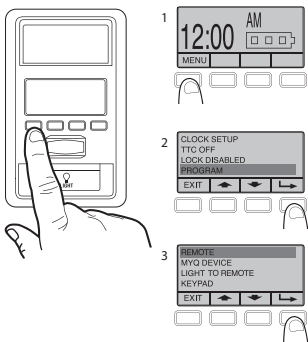

- 1. Select **MENU**.
- 2. Scroll down and select **PROGRAM**.
- 3. Scroll down and select **REMOTE**.

Do not follow on screen instructions. MOVE DIRECTLY TO STEP 03.

03



15 Seconds

Within 15 seconds of completing step 02, press and release the remote button you would like to program **three times**. The blue LED will flash intermittently.

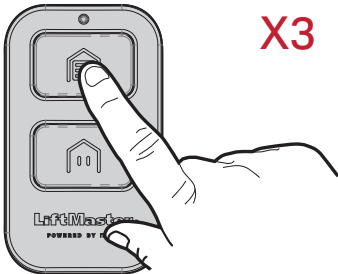

WARNING: Your garage door opener light will flash and your garage door will move.

04



3 Seconds

When your garage door moves, **within 3 seconds**, press and release any remote button.

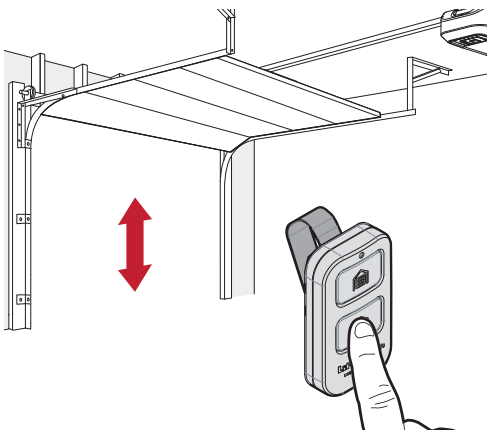

To test your remote has programmed successfully tap here.

Program Remote to Garage Door Opener Using a Program Button

IMPORTANT: Read through all programming steps before you start.

IMPORTANT: Have your garage door opener product manual available for the location of the program button and steps required to set your garage door opener into programming mode. See [page 4](#) for more information.

01

Press and hold the two buttons on the remote simultaneously until the blue LED stays on (typically within 6 seconds).

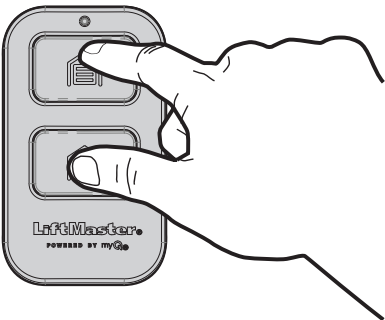

02

Set your garage door opener into programming mode.

Examples:

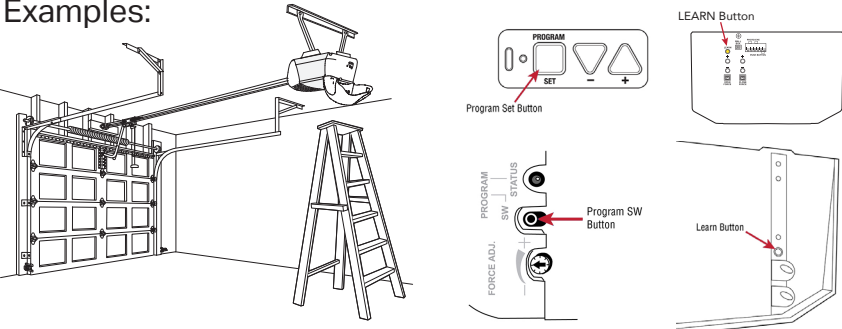

15 Seconds

03

Within 15 seconds of setting your garage door opener into programming mode, press and release the remote button you want to program **three times**. The blue LED will flash intermittently.



WARNING: Your garage door opener light might flash and your garage door will move.



3 Seconds

04

When your garage door moves, **within 3 seconds**, press and release any remote button.

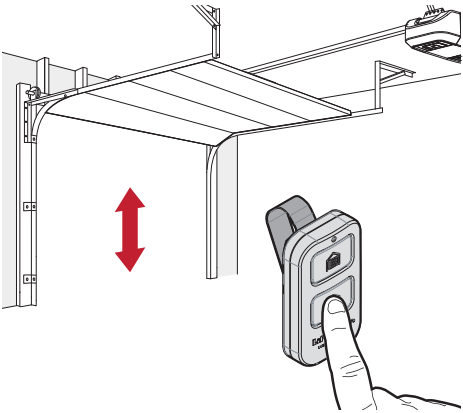

To test your remote has programmed successfully [tap here](#).

Options to Program Remote to a LiftMaster, Chamberlain, Craftsman, or Raynor Garage Door Opener with a White LEARN Button



There are three ways to program your remote to a garage door opener with a white LEARN button. Tap your preferred method below.

Option 1: To program your remote using the myQ app, **tap the myQ app icon.**



Option 2: To program your remote using garage door opener's LEARN button, **tap the LEARN button icon.**

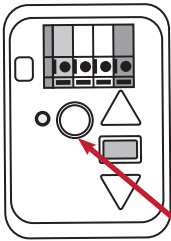

LEARN Button

Option 3: To program your remote using garage door opener's control panel, **tap the control panel icon.**

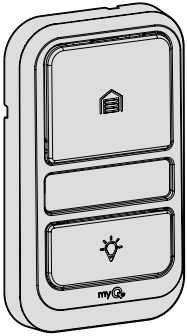

Program Remote to a LiftMaster, Chamberlain, Craftsman, or Raynor Garage Door Opener with a White or Yellow LEARN Button Using the myQ App

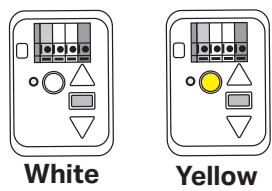

HIGHLY RECOMMENDED: Connect your garage door opener to the myQ app and program your remote to the garage door opener to unlock exciting features that include remote naming, notifications, and access history.

01 Look for a “Wi-Fi” or “Powered by myQ” logo to determine if your garage door opener is myQ compatible.

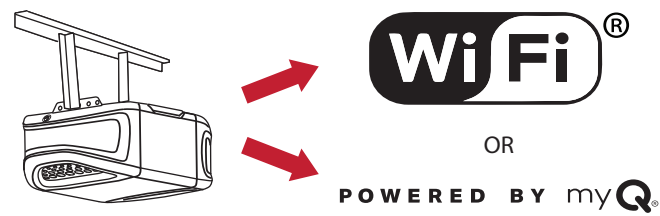

02 Tap or scan the QR code while using your smart device to download the myQ app. Follow the instructions in the app to connect to your garage door opener.



03 When your garage door opener is connected, scan the QR code on the reverse side of your remote, and follow the programming instructions in the myQ app.

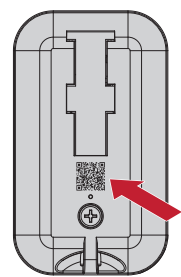

Once your remote is programmed in the myQ app, you can name your remote, view access history, and receive notifications when your remote activates the garage door opener.

Program Remote to a LiftMaster, Chamberlain, Craftsman, or Raynor Garage Door Opener with a White LEARN Button Using the LEARN Button



IMPORTANT: Read through all programming steps before you start.

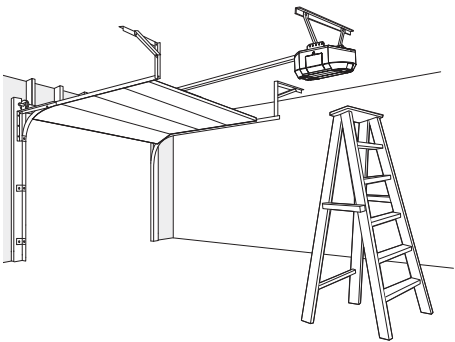

01 Press and **immediately** release the LEARN button.

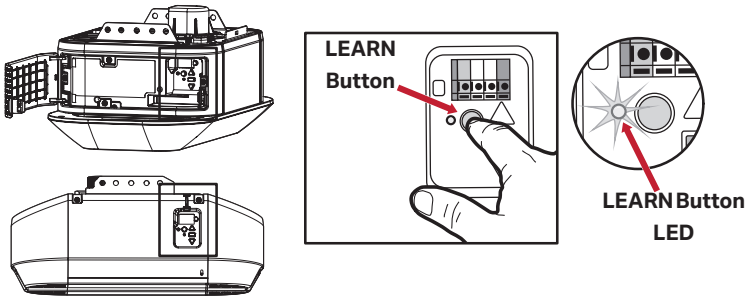

30 Seconds

02 **Within 30 seconds**, press and hold the remote button that you would like to program. Release the button when the garage door opener lights flash and/or two clicks are heard.

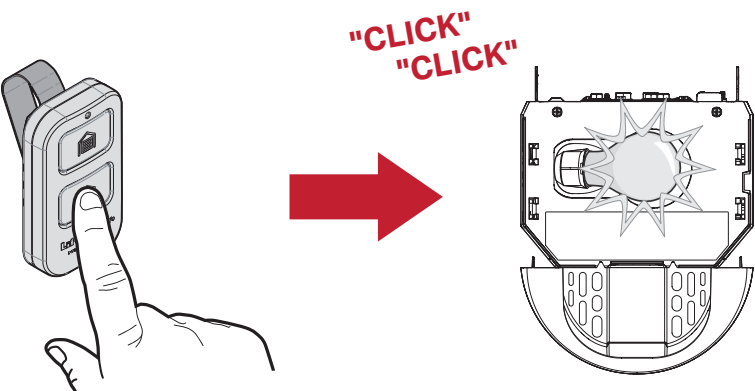

To test your remote has programmed successfully [tap here](#).

Program Remote to a LiftMaster, Chamberlain, Craftsman, or Raynor Garage Door Opener with a White LEARN Button Using the Control Panel



IMPORTANT: Read through all programming steps before you start.

01 Follow the instructions below for your control panel model to set your garage door opener into programming mode.

Control Panel

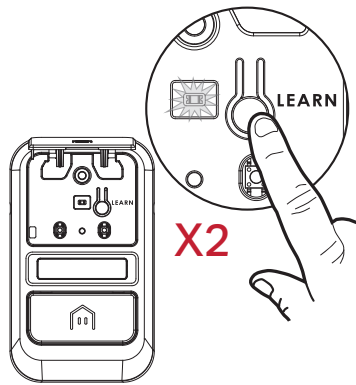

Lift the push bar. Press the LEARN button **twice**. The LED on the door control panel will pulse repeatedly.

Push Button Door Control

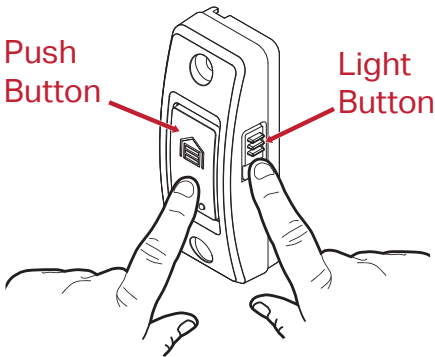

Press and hold the light button, then press and release the push button. The button LED will begin to flash.

Smart Control Panel

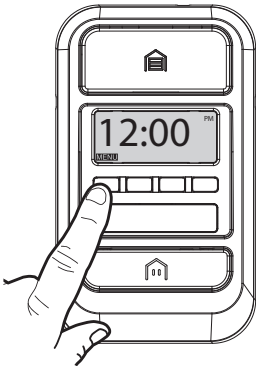

Select **MENU**, then select **PROGRAM** and follow on screen instructions.



30 Seconds

02 Within 30 seconds of completing step 01, press and hold the remote button that you would like to program. Release the button when the garage door opener lights flash and/or two clicks are heard.

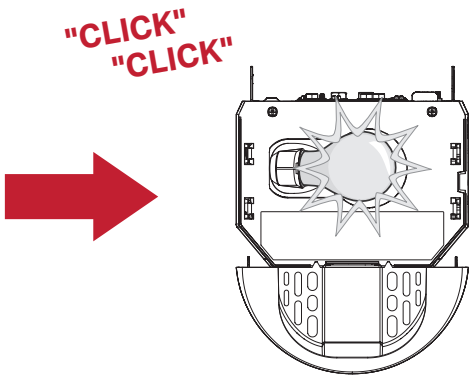
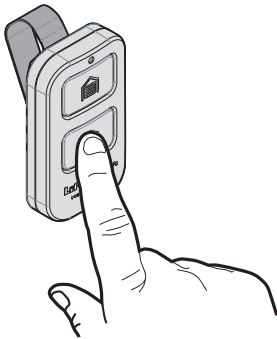

To test your remote has programmed successfully [tap here](#).

Test your Remote has Programmed Successfully

TEST FOR SUCCESS: Press the remote button that you programmed. The garage door opener will activate. If the garage door opener does not activate, wait for the garage door opener's program button LED to turn off (for a LiftMaster, Chamberlain, Craftsman, or Raynor garage door opener with yellow or white LEARN button this could take up to 3 minutes). Then repeat the programming steps, go to **"Programming the Remote"**.

TROUBLESHOOTING: If you are trying to program your remote to a LiftMaster, Chamberlain, Craftsman, or Raynor garage door opener with a white LEARN button and previously programmed the same remote to a garage door opener with a different program button, use the programming instructions on **page 7**. Please note: if you use these instructions, the garage door will not move - when the garage door opener lights flash and/or clicks once, the remote has programmed successfully.

Replacing the Battery

The LED on your remote will become dim or stop flashing when the battery is low and needs to be replaced. Replace the battery with only 3V CR2032 coin cell battery. Dispose of the old battery properly.

To replace the battery, follow the instructions as shown below. Reference the illustration below for each step.

01 On the back side of the remote, using a **Phillips #1** screwdriver, unscrew the captive screw until it rotates freely.

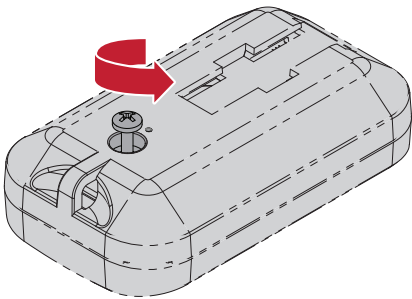

02 Pry the bottom housing from the top housing (if the housing will not separate, check that the captive screw is rotating freely).

NOTE: The logic board could detach from the remote top housing. If this occurs, carefully replace using the guiding hole in the logic board.

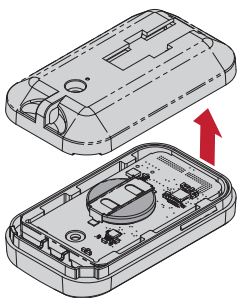

03 Following the "REMOVE" arrows direction printed on the logic board, with a cotton swab, push the old battery out of its holder.

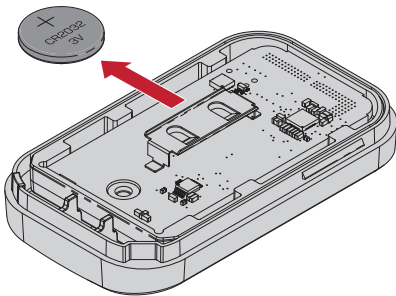

04 Following the "INSERT" arrow direction printed on the logic board, insert the replacement battery positive side up.

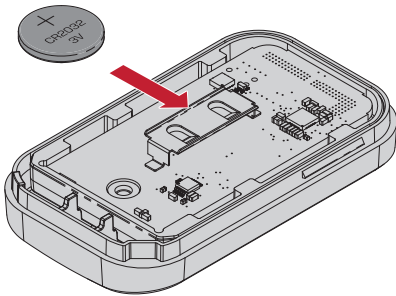

05 Align the remote bottom and top housing, checking that the screw holes line up, and press so they clip back together.

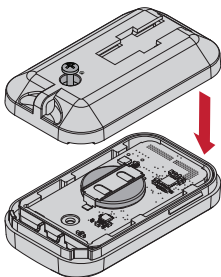

06 Tighten the captive screw until the top and bottom housing no longer shift (**do not overtighten the screw to avoid cracking the plastic housing**).

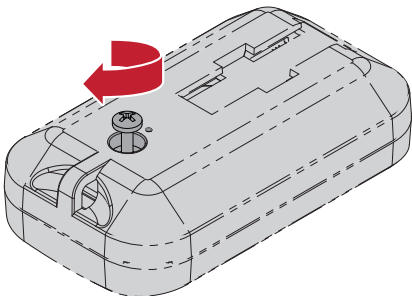

Replacing the Battery (continued)

⚠️

WARNING

- **INGESTION HAZARD:** This product contains a button cell or coin battery.
- **DEATH** or serious injury can occur if ingested.
- A swallowed button cell or coin battery can cause **Internal Chemical Burns** in as little as **2 hours**.
- **KEEP** new and used batteries OUT OF REACH of CHILDREN.
- **Seek immediate medical attention** if a battery is suspected to be swallowed or inserted inside any part of the body.

!

⚠️

WARNING

- Remove and immediately recycle or dispose of used batteries according to local regulations and keep away from children. Do NOT dispose of batteries in household trash or incinerate.
- Even used batteries may cause severe injury or death.
- Call a local poison control center for treatment information.
- Battery Type: CR2032
- Battery Voltage: 3 V
- Non-rechargeable batteries are not to be recharged.
- Do not force discharge, recharge, disassemble, heat above (manufacturer’s specified temperature rating) or incinerate. Doing so may result in injury due to venting, leakage or explosion resulting in chemical burns.

- Ensure the batteries are installed correctly according to polarity (+ and -).
- Do not mix old and new batteries, different brands or types of batteries, such as alkaline, carbon-zinc, or rechargeable batteries.
- Remove and immediately recycle or dispose of batteries from equipment not used for an extended period of time according to local regulations.
- Always completely secure the battery compartment. If the battery compartment does not close securely, stop using the product, remove the batteries, and keep them away from children.

16

Replacement Parts

Description	Part Number
Visor Clip	041-0494-000

Additional Resources

One Year Limited Warranty

The Chamberlain Group LLC ("Seller") warrants to the first consumer purchaser of this product that it is free from defect in materials and/or workmanship for a period of 1 year from the date of purchase.

For more information, visit: www.myq.com/warranty

Contact Us

For additional information or assistance, please visit: support.chamberlaingroup.com

NOTICE: This device complies with part 15 of the FCC rules and Innovation, Science and Economic Development Canada license-exempt RSSs. Operation is subject to the following two conditions: (1) This device may not cause harmful interference, and (2) this device must accept any interference received, including interference that may cause undesired operation. Any changes or modification not expressly approved by the party responsible for compliance could void the user's authority to operate the equipment.

HOW TO ORDER REPAIR PARTS

DEVANCO  **CANADA**

19192 HAY ROAD, UNIT Q
SUMMERSTOWN, ON, K0C 2E0

TOLL FREE **1-855-931-3334**
WWW.DEVANCOCANADA.COM

**WHEN ORDERING REPAIR PARTS
PLEASE SUPPLY THE FOLLOWING INFORMATION:**

- ✓ **PART NUMBER**
- ✓ **DESCRIPTION**
- ✓ **MODEL NUMBER**